

# TOP Design Rules: Microfluidic Building Block Port Layouts

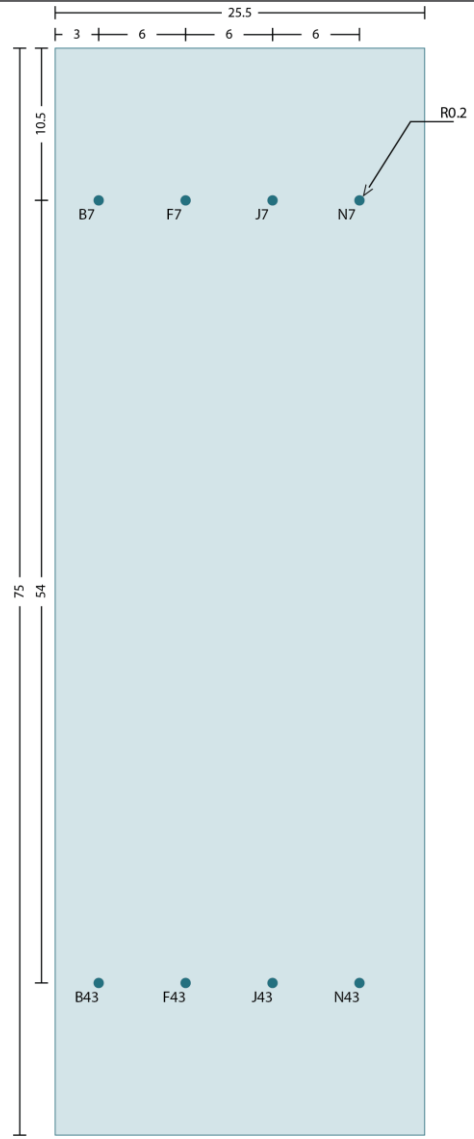

# Suggested tissue chip MFBB layouts

Units: mm



8p-MFBB 25.5 x 75

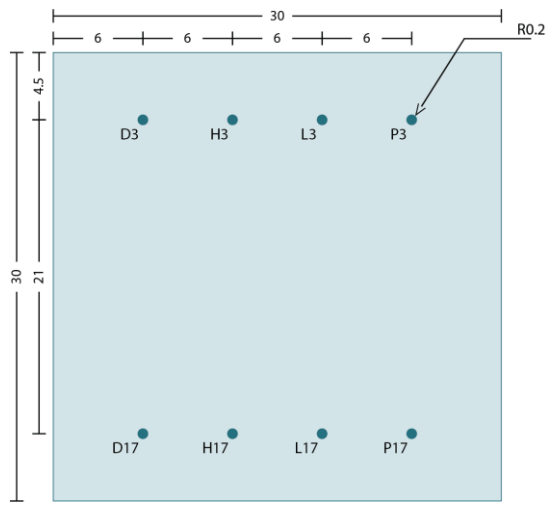

8p-MFBB 30 x 30



# Suggested technical block MFBB layouts

Units: mm

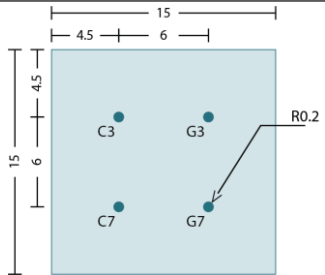

4p-MFBB 15 x 15

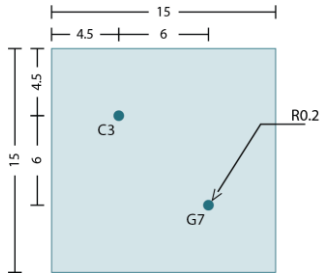

2p-MFBB 15 x 15

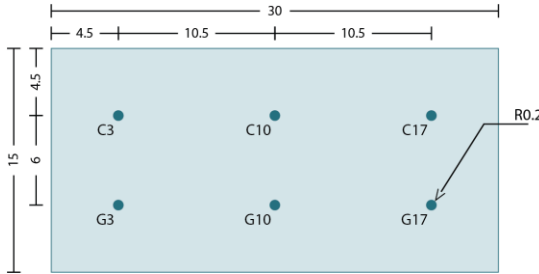

6p-MFBB 30 x 15

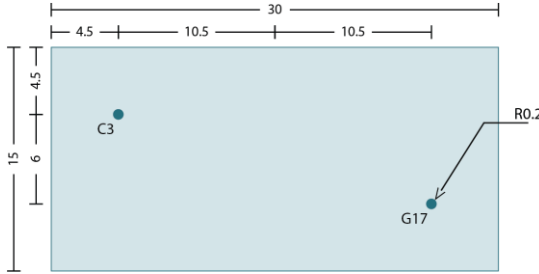

2p-MFBB 30 x 15





# Selecting subsets of MFBB port layouts

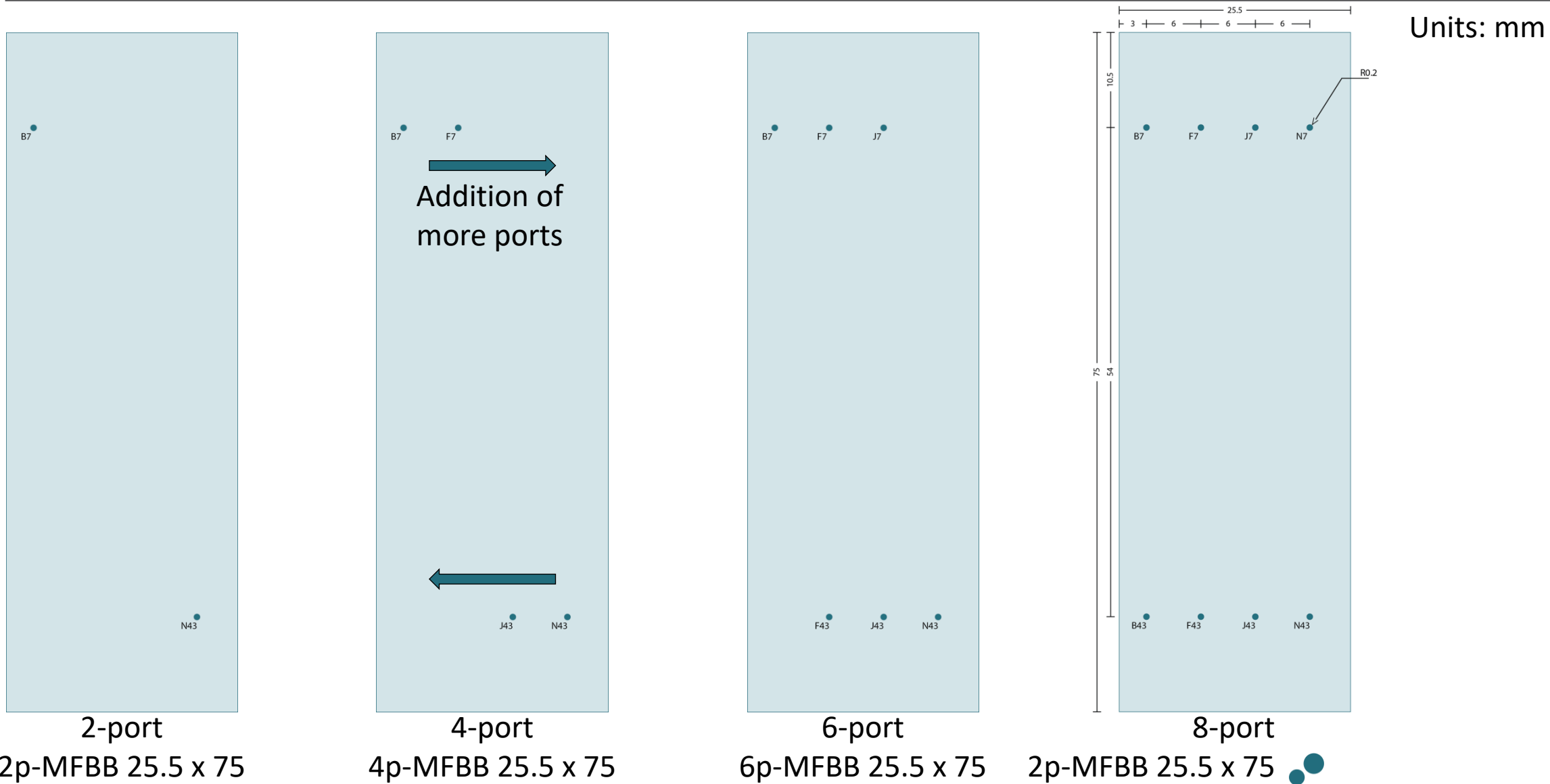



# Selecting subsets of MFBB port layouts

Units: mm

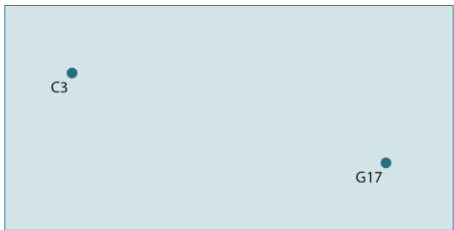

2-port  
2p-MFBB 30 x 15



4-port  
4p-MFBB 30 x 15

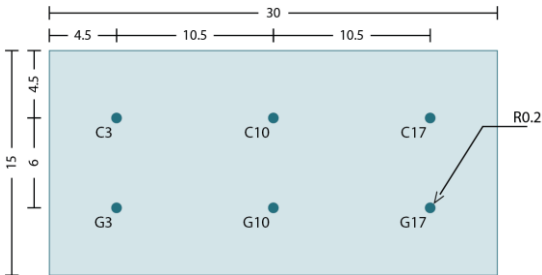

6-port  
6p-MFBB 30 x 15

# Exclusion zones and clamping areas

Units: mm

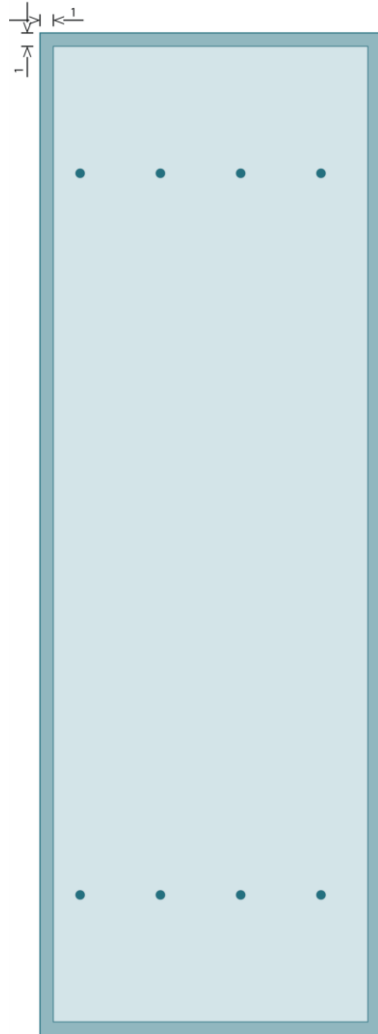

1-mm clamping area  
(required at clamping surface)

Isolated ports

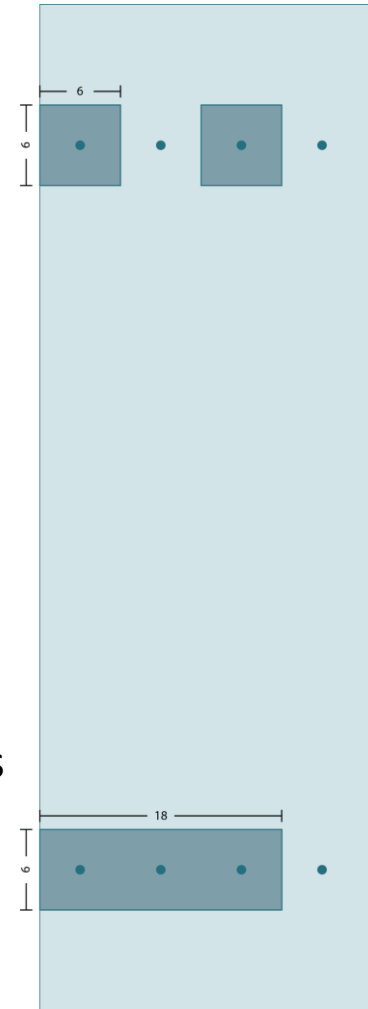

Adjacent ports

6-mm exclusion zones  
(required at interfacing surface)

Exclusion zones and clamping areas must be free of obstructions and/or chip elements to ensure leak-free interfacing



# Additional Resources

---

## ISO 22916:2022

- <https://connect.nen.nl/Standard/Detail/3676262?compId=16755&collectionId=0>

## Quick Start Design Guide

- <https://doi.org/10.4121/871d6c3a-cf1a-44f9-865a-6da842bd2f27>